

**Greenville Municipal Auditorium
Technical Description 2019**

General Information/Location/Capacity

2821 Washington St. Greenville, TX 75401

1930s vintage hall, stage is on second floor

Auditorium also houses city offices, generally open 8:00AM to 5:00PM, Monday thru Friday

Load-in elevator (8' X 6'9") at back of auditorium on Pickett St., Capacity 4,000 pounds

Load in door is 8' wide X 10' tall (roll-up style, can be noisy if windy outside)

Seating capacity approximately 1400 (880 main floor and 550 balcony)

Non-Union Non-Smoking by city ordinance

Contact for sound questions: Danny Beaver, 903-821-5656

Contact for Lighting questions: Joel Hydrick, 214-329-8001

Stage Layout (see attached sketch)

Proscenium Opening: 40ft wide by 19ft tall (15ft height to bottom of fixed border curtain)

Main Stage Depth: 30ft from audience side of proscenium to back wall

Stage Apron: 46ft wide by 12ft deep at center (curved downstage lip, 8ft deep at sides)

Cross Over: depends on which batten upstage curtain is hung, none behind cyc, cross-under possible

Wing Space: 5ft SR (limited by fly rail system), 12ft SL obstructed by Grand Piano & column

Stage floor: Oak T&G, apron floor on wooden floor joist system, main floor set over concrete

Orchestra Pit: 40ft wide, 5ft 8inches deep at center, 10ft deep at sides, floor sunken about 12inches

Curtains/Masking

Main Curtain: Maroon Velvet, motorized horizontal, controls back stage (15 seconds to open or close, can be stopped at any point) follows a curved path about 2ft upstage of stage lip

Traveler: Beige Velvet, just upstage of proscenium pillars, rope and pulley actuated

Flying Curtains: Two full black pleated heavy material (see batten schedule)

Flying Cyclorama: 35 feet wide by 18.5 feet tall, light blue, weighted at bottom

Fixed Border: Maroon Velvet, 4 feet tall

Flying Border (Teaser): Black pleated fabric, 5 feet tall

Flying Legs: Five black pairs (see batten schedule) pleated 6 feet wide, can track in/out & rotate

Bare Wire Power

SR Downstage wall: 3 phase X 200A box and 3 phase X 100A box

SR Upstage wall: 2 phase X 100A box and 2 phase X 50A box

Dressing Rooms

Stage Left: Small dressing room for up to 4 people with private bathroom, mirrors, & heater.

Stage Left: Large dressing room (Fiesta Room) for up to 50 people down short hall, with private bathroom.

Stage Right: Small dressing room for up to 4 people with adjacent bathroom, mirrors, & heater

Flying Batten System

Type system: Hemp rope, counterweighted, operated from stage floor level

Number and Type of Battens: Twenty 40ft long X 1.75inch diameter steel pipes

Working Height of Grid: 40ft (catwalk at 20feet)

Capacity of each line after balancing: 500 pounds

Distance from Downstage Lip of Stage to First Set: 14feet (just inside proscenium opening)

Distance from Downstage Lip of Stage to Last Set: 39feet 4inches (against upstage wall column)

Batten Spacing: 16inches

Batten Schedule

Line Number	Distance from Upstage Side of Proscenium Opening	Used For	Notes
1	0	Black Boarder	5 feet tall
2	16 inches	1 st Electric	
3	32 inches	Leg #1	
4	48 inches		FREE
5	64 inches	Leg #2	
6	80 inches		FREE
7	96 inches	2 nd Electric	
8	112 inches	Leg #3	
9	128 inches		FREE
10	144 inches	Full Black Curtain	
11	160 inches		FREE
12	176 inches		FREE
13	192 inches	Leg #4	
14	208 inches	3 rd Electric	
15	224 inches	Leg #5	
16	240 inches		FREE
17	256 inches	Full Black Curtain	
18	272 inches	Strip Lights (f/cyc)	
19	288 inches		FREE3
20	304 inches	Cyclorama	

Lighting System

House lighting: on separate dimming controllers at FOH position & backstage

Theatrical Dimming & Control System:

Lehigh Wave 120 Controller 30 channel 2-scene or 60 channel single scene manual operation, 120 submaster memories, 580 cue memories, 48 effects, USB interface, controls up to 512 dimmers (only have 67 available)

Flying Electric Pipe Battens: (see batten schedule for location) all receptacles 30A round twist lock

1 st Electric: 18 receptacles, (9 dimming circuits, 2.2kW each)

2 nd Electric: 14 receptacles (7 dimming circuits, 2.2kW each)

3 rd Electric: 14 receptacles (7 dimming circuits, 2.2kW each)

Flying Strip Lighting for Cyc: 4 Color (RGBY) 150W floods behind colored glass lenses

8 dimming circuits (2 for each color)

Back Wall Pockets: 8 receptacles, 4SL & 4SR, (4 dimming circuits, 2.2kW each) odd 3 prong

Apron Down Lighting: Architectural fixtures, part of house lighting, not on theatrical system

Side Booms:

1st pipe set: even with apron lip, bottom is 10ft above floor, top is 30ft above floor

8 receptacles each side (8 dimming circuits paired left & right, 2.2kW each)

2nd pipe set: 15feet further out in house, bottom is 15ft above floor, top is 35ft above floor

8 receptacles each side (8 dimming circuits paired left & right, 2.2kW each)

Front of House Lighting Positions:

1st pipe set: even with balcony railing, bottom is 4ft above balcony floor, top is 12ft above floor

4 receptacles each side (8 dimming circuits independent left & right, 2.2kW each)

2nd pipe set: 5feet further back, similar pipe height

4 receptacles each side (8 dimming circuits independent left & right, 2.2kW each)

Fixture Inventory: (all fixtures have color frames, no fixtures accept GOBOS)

6 - 8inch long throw ellipsoidals, 1000W, used for FOH lighting from balcony

8 - 6inch Lekos, 750W

8 - 6x9 Ellipsoidals, 575W

4 - 6x16 Ellipsoidals, 575W

12 - 6" Fresnels, 500W

24 - PAR56, 500W

12 - Scoops, 1000W

Follow Spots: 2- HMI Comets at Balcony rail, 500W

Miscellaneous:

One light duty fog machine, more of a hazer

One multicolor Sound Activated Halogen Moving Moon Flower "Party" fixture

Two Red & Green LED Sound Activated Moving head Moon Flower fixtures

One small Mirror ball with motor

Several extension cords for 30A round twist lock receptacles

A few adapter cords for odd receptacles in back wall pockets

Three "Two-fers" or splitters with 30A round twist lock receptacles

Two sets of pipe stands suitable for rigging foot lights (use side boom dimmer circuits)

Several wooden floor stands for rigging "Up Lighting"

Audio System

Front of House Console: Midas M32-IP 32 Microphone Inputs and Six Aux Inputs Mixer located in the center section of the main floor 58' from the orchestra pit. The M32-IP is connected to a Midas DL32 Stage Box via AES-A located in the equipment rack located stage left. A Cat5e connector is located on the side of the rack connected to AES-B of the DL32 for a Monitor Console.

Two additional Cat5e connections are available for guest mixers or lighting console from Front of House to the equipment rack.

CD/Bluetooth/3.5mm Player: TASCAM Model CD200-BT

Front of House Speakers: Flown Left and Right, 1 JBL VRX918S and 4 JBL VRX932LA-1 each side. One JBL SRX728S Sub-woofer is located under the stage (Center)

Front of House Processor and Amplifiers: Ashley NE24.24M Processor. Crown DCi2-1250 Amplifiers for the VRX Speakers and a QSC RMX1850HD connected to the SRX728S.

Front Fill System: 4-QSC I-82H (8" 2-way low profile 8Ω rated for 200W) Powered by a QSC CMX300 Amplifier.

Under-Balcony System: 6-Duplex Loudspeakers digitally delayed from Front of House. Powered by a QSC CMX300 Amplifier.

Monitor System: 4 EV TX1122FM Wedge Speakers and 2 EV TX1152FM Wedge Speakers Driven by 2 QSC RMX1850HD Amplifiers providing four mixes from Front of House. Two 30' and Four 50' Speaker Cables.

Stage Boxes: Four 50' labeled Microphone Inputs 1-12, Microphone Inputs 13-18, Microphone Inputs 19-24 and Microphone Inputs 25-32.

Microphones & Stands:

4-Shure QLXD24/SM58-H50 Hand-held Wireless Systems & 2-Body-packs and 2 Ear Set Microphones.

4-Shure Beta 58A Solo vocal Mics

3-Shure SM58 Solo vocal Mics

4-Shure SM57 Instrument Mics (plus 3 more in drum mic kit listed below)

4-EV N/D 257 Solo vocal Mics 4-EV CS15P Cardioid Condenser Mics

4-Crown PCC-160 Boundary (Floor) Mics

1-Shure Drum Mic kit DMK57-52 (includes 3 SM57 Mics, 1 Beta 52A Mic, 3 rim mounts)

4-Sennheiser E604 Drum Mics

4-Sennheiser E609 Guitar Amp Mics

10-K&M 21075 Stands and Booms

8-Atlas Mic stands with Boom attachments (4 telescoping, 4 fixed length adjustable) 4-Peavey Straight Mic stands & 3 Atlas Short straight stands (for guitar amps or kick mic)

Microphone Cables: 3' to 30'

Intercom System: Hard Wired Telex with 10 belt-packs & headsets

Direct Boxes: 4-Whirlwind IMP2 (standard passive DI boxes)

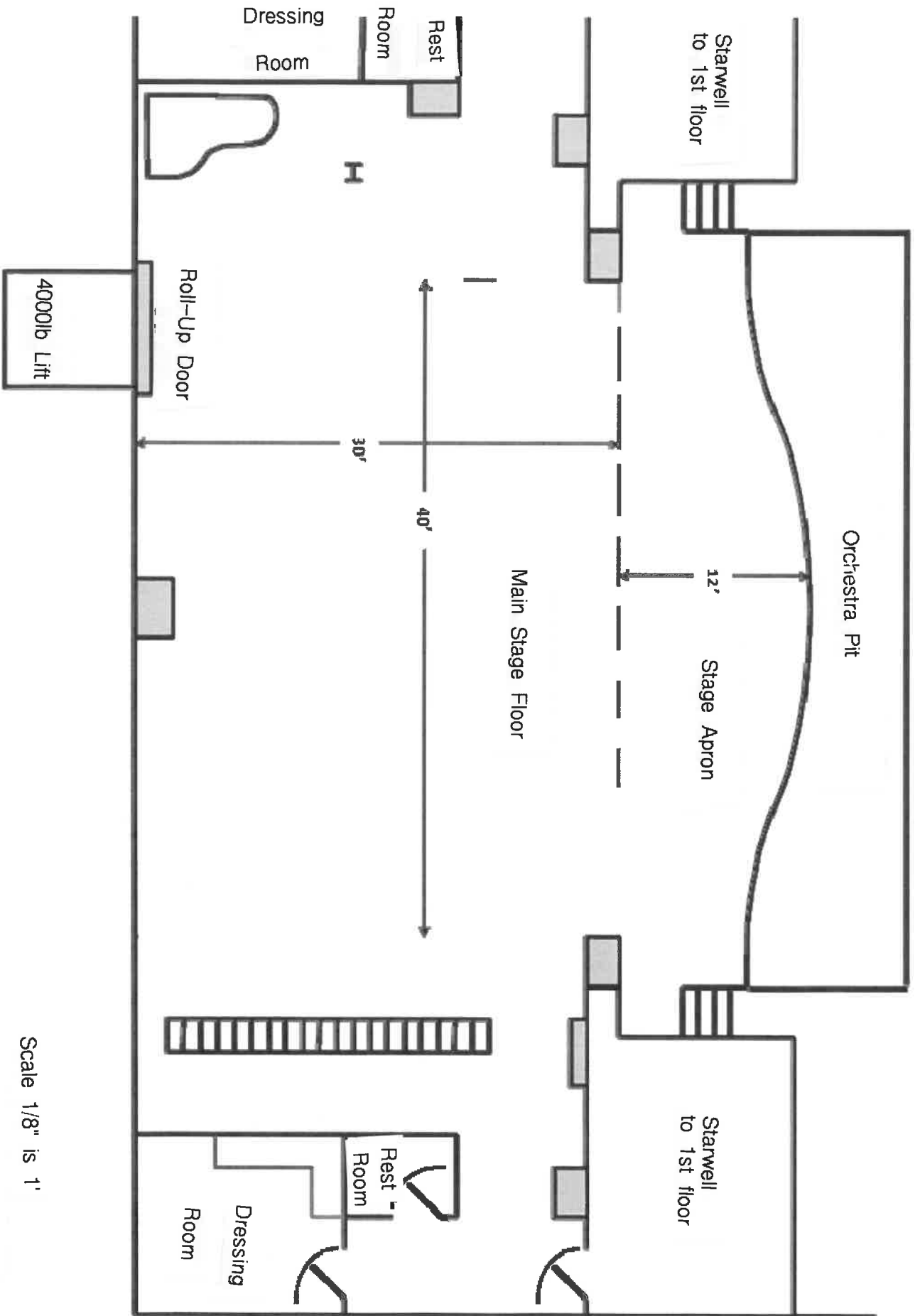

Scale 1/8" is 1'